

총람

제품 장점

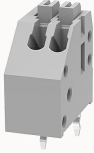

DG250-2.5 reverse pin pattern-10060000022

PCB spring terminal blocks, Rated current: 2A. Rated voltage
(III/2) : 250V, pitch: 2.5mm, Color: gray, Contact surface : Tin

제품 장점

- ☒ PUSH-IN connection technology, fast wiring
- ☒ 45° connection can realize multi-row layout on PCB
- ☒ Universal installation method, suitable for various situations

제품 인증



기술 데이터

제품 도면

3D

□

Processing notes

Process

Wave soldering/manual soldering

Connection capacity

Conductor cross section solid

0.2~0.5mm²

Conductor cross section flexible

0.2~0.5mm²

AWG

24~20AWG

Strip length

9mm

Electrical parameters UL

Rated voltage (B)

300V

Rated voltage (C)

300V

Rated voltage (D)	300V
Rated current (B)	2A
Rated current (D)	2A
Rated current (C)	2A

Electrical parameters IEC

Rated voltage	250V
Rated current	2A
Rated current(III/2)	250V
Rated surge voltage(III/2)	2KV

Item properties

Connection direction	45°
Type of installation	PCB welding
Pin arrangement	Double-row of misalignment
Connection method	Push-in spring connection
Pitch	2.5mm
Number of potentials	2
Pluggable or not	no
Number of rows	1

Material data

Environmental items	Compliant with REACH/RoHS
Contact material	Copper alloy
Contact point metal surface	tin-plated
Insulation Materials	PA66
Insulating material group	I

Flammability rating	UL94V-0
Mechanical tests	
Test Specification	UL1059/IEC60998
Environmental data	
Ambient temperature (operation)	-40℃~105℃

악세사리	
Accessories	
Coding strip	/
Bridge	/
Marking strip	/
Others	/
Tool	
Operating tool	/
Screwdriver	/

비즈니스 데이터	
발주 번호	10060000022
포장 단위	2900
MOQ	30
제품 무게 (포장 제외)	0.87