

02P:Clasp on the left
from this view

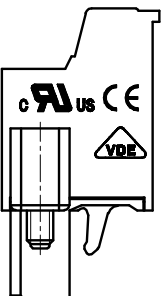
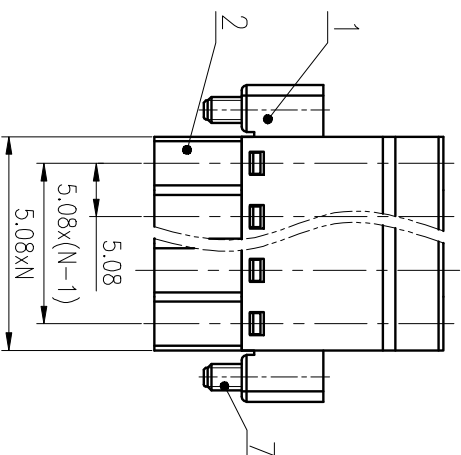
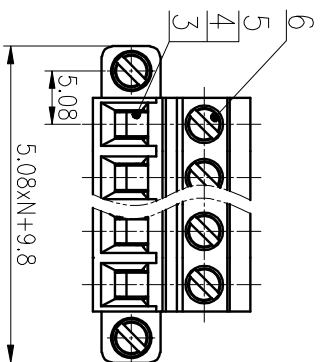
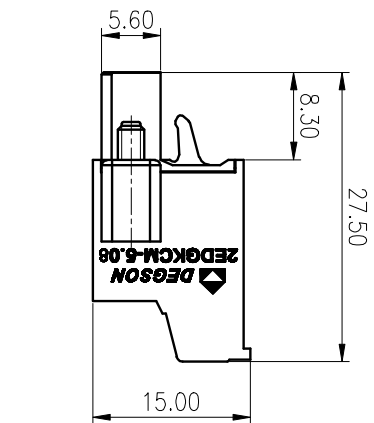
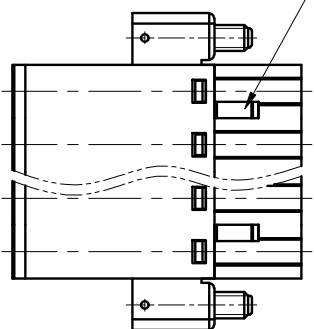

公差等级/General Tolerances(mm)	
0	>3
~	>6
3	10
6	18
±0.12	±0.18
±0.22	±0.26
±0.31	±0.37
±0.57	±0.80
±0.93	±1.05
±1.15	±1.60
±2.20	±2.50
±Z	

7	Screw2	Steel	M2.5/Zn Plated
6	Screw1	Steel	M2.5/Zn Plated
5	Cage	Steel	M2.5/Zn Plated
4	Block	Steel	Zn Plated
3	Clamp	Copper alloy	Sn Plated
2	Cover	PA66	UL94V-0
1	Housing	PA66	UL94V-0

ITEM	NAME OF PART	MATERIAL	NOTES
UL 标准/UL Standard: B C D			
额定电压/电涌/Rated Voltage(V)/Current(A) 300/101150/101300/70			
IEC 标准/IEC Standard: B C D			
过压类别/Overvoltage Category/污染等级 III/3 III/2 II/2			
污染度/Pollution Degree / 3/0/2/0 /			
额定电压/电涌/Rated Voltage(V)/Current(A) / 3/0/2/0 /			
额定脉冲电压(kV)/Rate Impulse Voltage(kV) / 4.0 /			
额定扭矩/扭矩 Tightening(N·m/Lb·in) M2.5: 0.4/3.5/4			
线芯范围(硬线和软线)/Wire Range(rigid and flexible)(mm ² /AWG) 0.2~2.5/28~12			
间距/Pitch(mm)/线数范围/Poles 5.08/N=02~24P			
剥线长度/Stripping length(mm) 9~10			
使用温度范围/Operating temperature(°C) -40~+105			
符合RoHS标准/Conform to RoHS Yes			

MATERIAL:	
MAT NO.:	/
STATUS:	/

SURFACE:	
APPD:	Lan CHH 2020.06.24
CHKD:	Yu JZh 2020.06.24
DRAFT:	YINDK 2019.07.03

NAME:	2EDGKCM-5.08-XXP-1Y-00A(H)
DRAWING NO.:	2EDGKCM-5.08-C01
TYPE:	CUSTOMER DRAWING
SCALE:	1.5:1
SHEET	1/1

REV	ECN	DESCRIPTION	DRAFT	DATE	SIZE: A4	TYPE: CUSTOMER DRAWING	SCALE: 1.5:1	SHEET
1								1/1

1 2 3 4 5 6

D B A